



9089 KNOLLING LOOP

Ooltewah, TN 37363 | Bainbridge

\$519,900

Sq Ft: 2,659 Bedrooms: 4
Baths: 3 Stories: 2

Nestled in desirable Ooltewah, Pratt Home Builders presents to you the coveted Peachtree home plan. With 4 spacious bedrooms and 3 full baths, this home is the epitome of family-focused living. Need more room for hobbies or a kids' play room? Check out the finished bonus room upstairs with walk-in attic storage. Indulge in a luxurious guest suite with full bath on the main level, along with a formal dining room, mud room, kitchen, and great room. The master bedroom offers an expanded bath with a large shower and soothing soaking tub. You'll find two secondary bedrooms located on the upper level along with the finished bonus. The covered back porch is a perfect spot to relax and unwind after a long day. It's worth mentioning that this home has been specially enlarged from the usual Peachtree plan, so don't miss this unique opportunity to live in such a stunning neighborhood like Bainbridge; close to dining, shopping, and plenty of parks.

Sales Office
9246 Knolling Loop
Ooltewah, TN 37363

Office Hours

- Finished Bonus Room
- 4 Bedrooms
- 3 Bathrooms
- Downstairs Bedroom

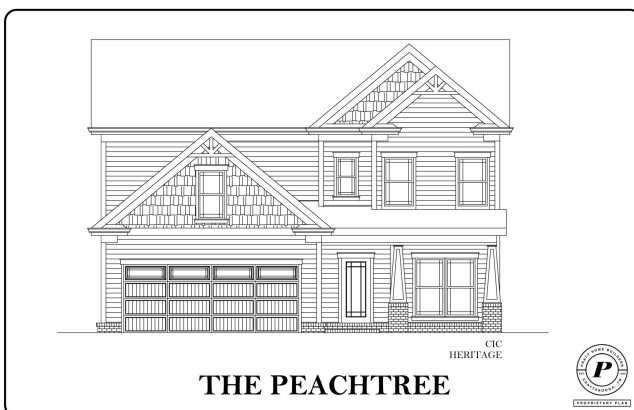

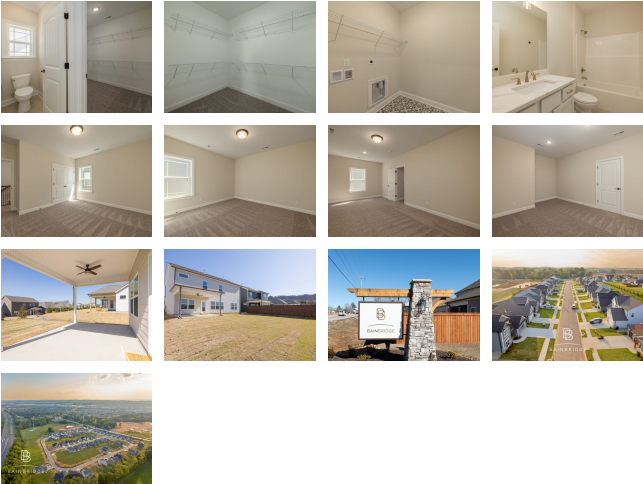
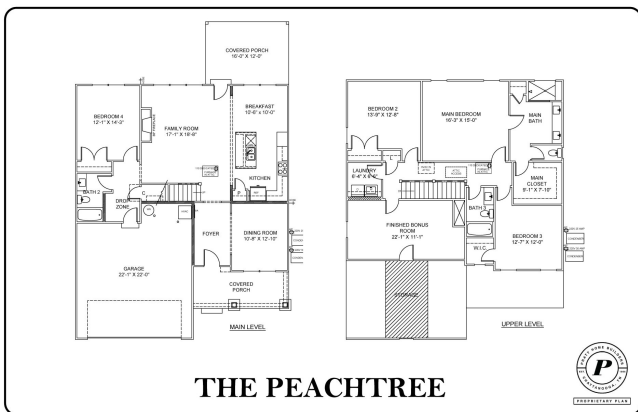

Home Site #87: The Peachtree

9089 KNOLLING LOOP

Hardie Siding: Cobble Stone

Front Door Color
SW0005 Deepest Mauve

Accent Brick

Front Door
Hardware

Shake Color

Exterior Mood Board

Home Site #87: The Peachtree

9089 KNOLLING LOOP

Warm & Cozy LVP Flooring

Wall
Colors

Upgraded Quartz
Countertops

Two Toned
Cabinets

Interior Mood Board

Classic Subway
Tile Backsplash
*Herringbone Install