



8131 PENNANT PLACE

Chattanooga, TN 37421 | Engel Park

\$509,900

Sq Ft: 2,651 Bedrooms: 4
Baths: 3 Stories: 2

Homesite 39 - If you're seeking both space and style, look no further than the Peachtree floor plan - a fan favorite for years. With maximized space of just under 2,700 square feet, this 4 bedroom, 3 full bathroom home is versatile and sure wow you. As you enter the wide foyer, you'll find the elegant dining room to your side. The open-concept great room is next, featuring an L-shaped kitchen with granite countertops and a dedicated pantry. A cozy guest bedroom and full bathroom are also situated off the great room. Moving upstairs via the hardwood stair treads, you'll find a laundry room at the landing, complete with tiled flooring. The bonus room is conveniently located just off to one side. The second level also includes two more guest bedrooms, a full bath, and the primary bedroom with an en suite bathroom and a closet. Currently under construction in Engel Park, this community is tucked away close to the Georgia state line just off of East Brainerd Road in the ever-popular Hamilton Place area. Engel Park was previously owned by the Engel family of the Chattanooga Lookouts, so you'll notice a nod to baseball throughout the community amenities. Community green spaces invite homeowners to start a pick-up game of neighborhood ball, enjoy the dog park, or just stretch out and enjoy the sun by the community pool. Don't miss out on this gem!

Sales Office
8016 Slugger Way
Chattanooga, TN 37405

Office Hours

- 4 Bedrooms
- 3 Full Bathrooms
- 2 Car Garage

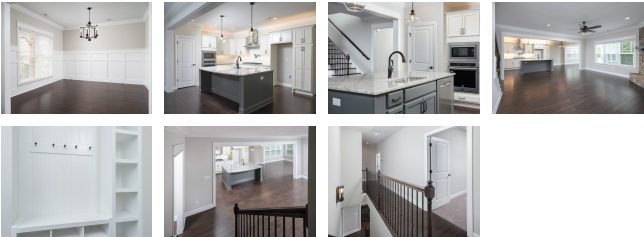

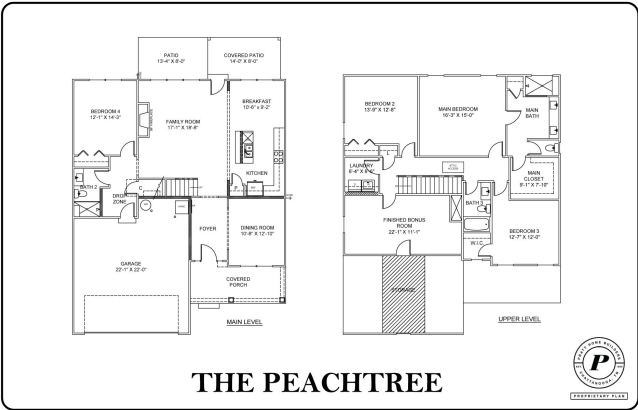

THE PEACHTREE

Home Site #39: The Peachtree

8131 PENNANT PLACE



Home Site #39: The Peachtree

8131 PENNANT PLACE

